

# Gerbür Floor Care Maintenance Guide

Applicable to Gerbür Vision - Gerbür Essential - Gerbür Nature,  
Gerbür Aqua Click Collections & Gerbür Art Collection

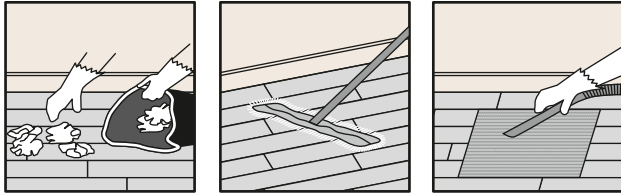

## DAILY SWEEPING AND DUST MOPPING



- Pick up litter and thoroughly sweep floor area using a dry dust mop
- Pick up debris with dustpan and brush
- Vacuum entrance mats and crevices at all entrances

## MANUAL MOPPING

Manual Mopping is used for soil removal in small or congested areas (including within large floors) and some mark removal. Spray cleaning with Gerbür Spot Cleaner may be required for heavier surface marking.

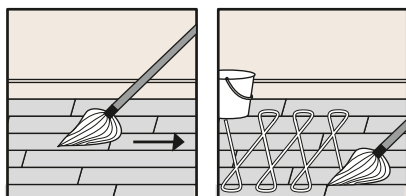

- Put out signs to warn people that cleaning is in progress
- Prepare a solution of Gerbür Routine Cleaner diluted in accordance with the instructions on the label.
- Using a two-bucket mopping system, apply solution using a damp mop to remove soiling
- Mop using overlapping strokes
- Rinse the mop frequently and change the solution as necessary
- Allow entire floor area to dry thoroughly
- Remove "caution" signs
- Ensure all equipment is cleaned thoroughly after use and stored safely

## TIPS

- In conditions of heavy soiling, perform a pre-wash by preparing a solution of PH Neutral Detergent diluted in accordance with instructions on the container and pre-wash heavily soiled areas.
- Where dirt has become ingrained over time we would recommend that the floor is deep cleaned.
- To help remove stubborn scuff marks use a non abrasive 3M red pad or equivalent.
- Any surface marking that is not removed by routine Manual Mopping may be removed by occasional spray cleaning using Gerbür Spot Cleaner.
- Spills of water, grease, food, chemicals and other foreign matter or use of inappropriate cleaning products may cause the floor to become slippery. Wipe up spills immediately with an absorbent cloth, then wash thoroughly with a properly diluted Gerbür Routine Cleaner or Gerbür Spot Cleaner until the spill area is completely clean. Rinse and allow to dry thoroughly.
- At least once a year the floor should be scrubbed thoroughly to remove in-grained dirt and floor dressing if applied.